



STEP-BY-STEP GUIDE TO ENTERING ONLINE

1. Google Account

- Ensure you have a Google account before submitting your entry. This is to verify identity and allow you to access the form.

2. Payment

- Follow the payment guide below and have your confirmation of payment ready.

2. Entry Form

- Fill in the online form, uploading your confirmation at the end.

- ❖ Please make sure you have a [Google account](#) in preparation to fill in the entry form.
- ❖ Details of competitions and entry fees are available in our [syllabus](#), downloadable from our [Feis webpage](#). Please make your payment as follows:

Payment details

Please transfer your fees to **"Friends of McGahan Lees"**

Sort code: **401804**

Account number: **61557912**

IBAN: **GB52HBUK40180461557912**

Branch: **26 High Street, Colchester, Essex, CO1 1DQ (HBUKGB4103U)**

Reference*: **MCGLFEIS [Dancer surname] [Dance school]**

*Please provide a reference for your transfer in the format:

"MCGLFEIS [Dancer surname] [Dance school]" (or as much of this as you can fit within your character limit). This will help us to match payments.



[Click here to access the entry form](#)

Please fill in ONE ENTRY FORM PER DANCER or CEILI TEAM, according to these instructions:

Solo dancer competitions

Fill in your email address and select “solo competitions” on the first page.

Enter dance school, competitor name, and select competition type.

For those entering open/prelim championship AND grade dances, please enter open/prelim championship first as you'll then have the option to enter grades too.

Open and preliminary championships:

All you need to do is select your age group, then select whether you want to enter any graded solos as well. If so, read on. If not, skip ahead to “final steps” below.

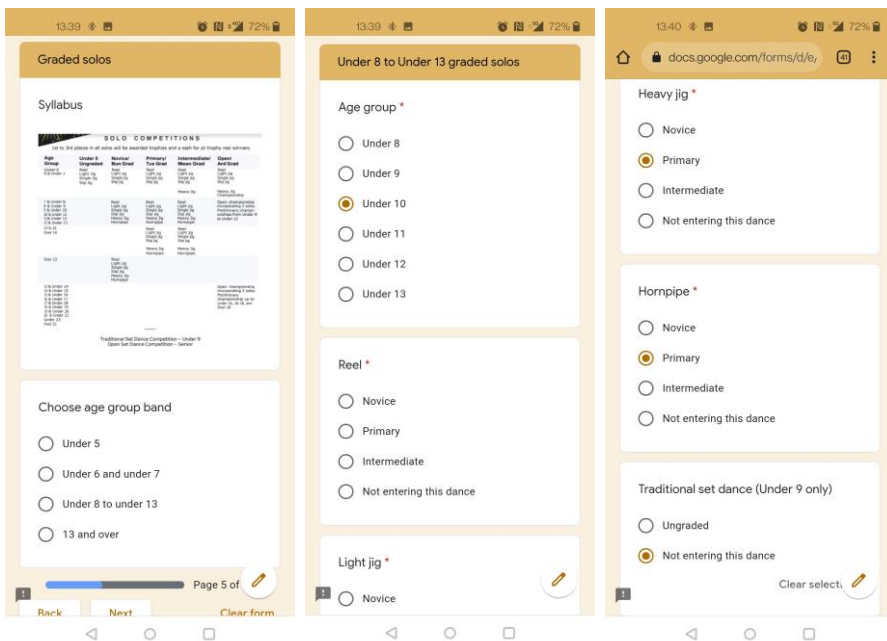

Graded solos:

First, choose your age band.

Next, select your exact age group

Finally, select your grade for each dance individually (or select “not entering this dance”).

Figure/céili teams

Select “Figure/céili competition” from the first page. Then, simply fill in school name, team name (e.g., Team A, Team B), age group, and competition type. Complete a separate entry form for each Team.

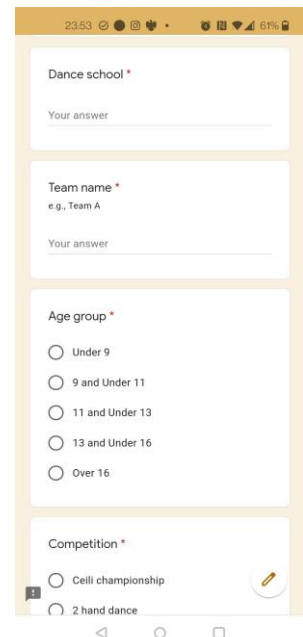



Final steps...

13:40

Acknowledgements

By submitting an entry to the McGahan Lees Open Feis 2022 you hereby acknowledge and agree that:

1. All entrants and spectators agree to adhere to whatever government guidance that is in place in relation to the control and spread of COVID-19 or any other variants. *

I agree

2. All entrants acknowledge that on entering this event they will be providing personal information in accordance with the current GDPR regulations. This information will be held and used by the feis organiser strictly for any activity relating directly to the event itself and will be destroyed within 7 days of the last competition ending. *

I agree

3. You have discussed and agreed your

Once you've entered your competition/s, you'll be asked to agree to our **terms and conditions**.

Finally, you'll need to complete our **payment** page using the details and confirmation of your bank transfer.

If you experience any difficulty with payment, please [get in touch](#).

13:40

Total amount paid *

If paying a family fee for 2 or more dancers, please enter the family fee for the first dancer and FF for the remaining dancer/s.

Your answer

Transfer reference *

Please provide the reference you assigned to your transfer, i.e., "MGLFEIS [Dancer Surname] [School]". This will help us to match your payment.

Your answer

Please upload your payment confirmation here.

[Add File](#)

Payment notes

Please provide any notes about your payment, e.g., "Family fee for [Names]".

Your answer

Thank you for your entry!